



**GROUND/TERM BAR
PRODUCT MANUAL FOR
P/N 111-3774**

PM 990-3774-00, Rev. 7

UNIPOWER, LLC
65 Industrial Park Rd
Dunlap, TN 37327
Phone: +1-954-346-2442
Toll Free: 1-800-440-3504
Web site – www.unipowerco.com

RECEIVING INSTRUCTIONS & GENERAL EQUIPMENT INFORMATION

Please Note: For your protection, the following information and the product manual should be read and thoroughly understood before unpacking, installing, or using the equipment.

UNIPOWER, LLC presents all equipment to the delivering carrier securely packed and in perfect condition. Upon acceptance of the package from us, the delivering carrier assumed responsibility for its safe arrival to you. Once you receive the equipment, it is your responsibility to document any damage the carrier may have inflicted, and to file your claim promptly and accurately.

1. PACKAGE INSPECTION

- 1.1** Examine the shipping crate or carton for any visible damage: punctures, dents, and any other signs of possible internal damage.
- 1.2** Describe any damage or shortage on the receiving documents, and have the carrier sign their full name.
- 1.3** If your receiving freight bill notes that a Tip-N-Tell is attached to your freight, locate it. If the Tip-N-Tell arrow has turned even partially blue, this means the freight has been tipped in transport. Make sure the carrier notes this on your receipt before you sign for the freight.

2. EQUIPMENT INSPECTION

- 2.1** Within fifteen days, open the crate and inspect the contents for damages. While unpacking, be careful not to discard any equipment, parts, or manuals. If any damage is detected, call the delivering carrier to determine appropriate action. They may require an inspection.

***SAVE ALL SHIPPING MATERIAL FOR THE INSPECTOR TO SEE!**

- 2.2** After the inspection has been made, call UNIPOWER. We will determine if the equipment should be returned to our plant for repair, or if some other method would be more expeditious. If it is determined that the equipment should be returned to UNIPOWER, ask the delivering carrier to send the packages back to UNIPOWER at the delivering carrier's expense.
- 2.3** If repair is necessary, we will invoice you for the repair so that you may submit the bill to the delivering carrier with your claim form.
- 2.4** It is your responsibility to file a claim with the delivering carrier. Failure to properly file a claim for shipping damages may void warranty service for any physical damages later reported for repair.

3. HANDLING

Equipment can be universally heavy or top-heavy. Use adequate manpower or equipment for handling. Until the equipment is securely mounted, be careful to prevent the equipment from being accidentally tipped over.

4. NAMEPLATE

Each piece of UNIPOWER equipment is identified by a part number on the nameplate. Please refer to this number in all correspondence with UNIPOWER.

5. INITIAL SETTINGS

All equipment is shipped from our production area *fully checked and adjusted*. Do not make any adjustments until you have referred to the technical reference or product manual.

6. SPARE PARTS

To minimize downtime during installation or operation, we suggest you purchase spare fuses, circuit boards and other recommended components as listed on the Recommended Spare Parts List in the back of the product manual. If nothing else, we strongly recommend stocking spare fuses for all systems.

PRODUCT SUPPORT

Product support can be obtained using the following addresses and telephone numbers.

Manufacturing facility:

UNIPOWER, LLC
65 Industrial Park Rd
Dunlap, TN 37327
United States

Phone: +1-954-346-2442

Toll Free: 1-800-440-3504

Web site – www.unipowerco.com

When contacting UNIPOWER, please be prepared to provide:

1. The product model number, spec number, S build number, and serial number - see the equipment nameplate on the front panel
2. Your company's name and address
3. Your name and title
4. The reason for the contact
5. If there is a problem with product operation:
 - Is the problem intermittent or continuous?
 - What revision is the firmware?
 - What actions were being performed prior to the appearance of the problem?
 - What actions have been taken since the problem occurred?

REVISION HISTORY

REV	DESCRIPTION	CHECKED/APPROVED BY & DATE
6	See PCO 45404	CJM / 8-8-19
7	See ECN 46140	JPR/ 1-3-24

PROPRIETARY AND CONFIDENTIAL

The information contained in this product manual is the sole property of UNIPOWER, LLC. Reproduction of the manual or any portion of the manual without the written permission of UNIPOWER, LLC is prohibited.

© Copyright UNIPOWER, LLC 2015

DISCLAIMER

Data, descriptions, and specifications presented herein are subject to revision by UNIPOWER, LLC without notice. While such information is believed to be accurate as indicated herein, UNIPOWER, LLC makes no warranty and hereby disclaims all warranties, express or implied, with regard to the accuracy or completeness of such information. Further, because the product(s) featured herein may be used under conditions beyond its control, UNIPOWER, LLC hereby disclaims and excludes all warranties, express, implied, or statutory, including any warranty of merchantability, any warranty of fitness for a particular purpose, and any implied warranties otherwise arising from course of dealing or usage of trade. The user is solely responsible for determining the suitability of the product(s) featured herein for user's intended purpose and in user's specific application.

Throughout the remainder of this manual, "UNIPOWER" will mean "UNIPOWER, LLC."

PERSONNEL REQUIREMENTS

Installation, setup, operation, and servicing of this equipment should be performed by qualified persons thoroughly familiar with this Product Manual and Applicable Local and National Codes. A copy of this manual is included with the equipment shipment.

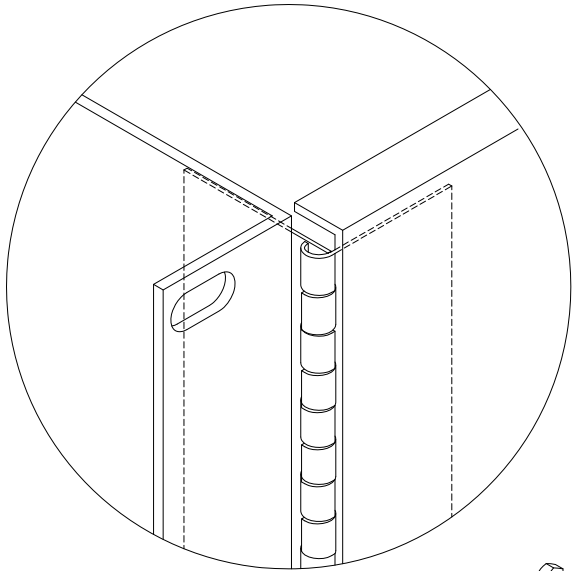

HINGE DETAIL

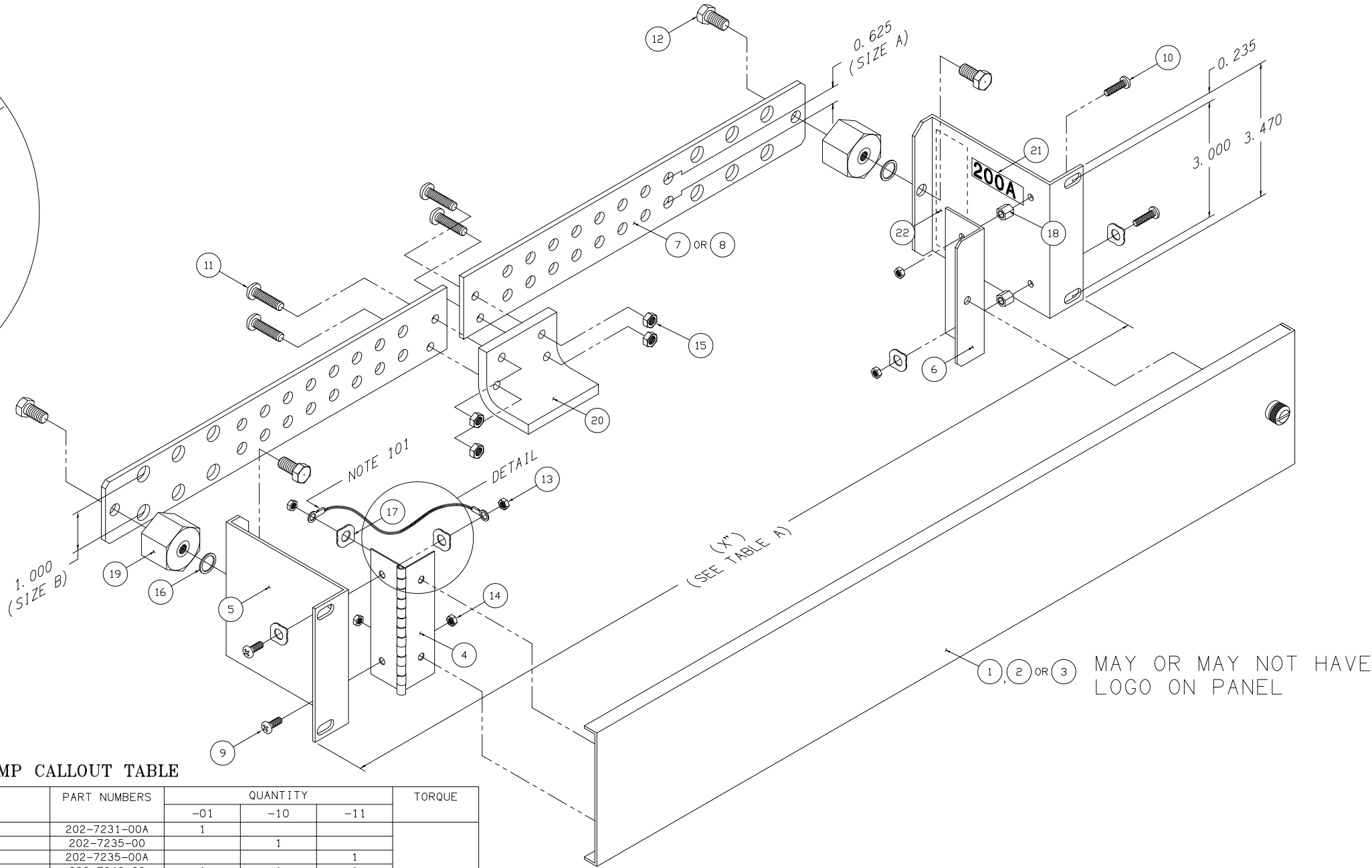

200 AMP CALLOUT TABLE

NOTE	REF #	DESCRIPTION	PART NUMBERS	QUANTITY			TORQUE
				-01	-10	-11	
	1	GRD/TERM HINGED PANEL, 19" x 3.5"	202-7231-00A	1			
		FRONT ACCESS HINGED COVER, 3.5" x 23"	202-7235-00		1		
		GRD/TERM HINGED PANEL, 23" x 3.5"	202-7235-00A			1	
		HINGE: 3.5" PANEL COVER	202-7240-00	1	1	1	
	5	BRKT, UNIVERSAL: FRONT ACCESS GRD/TERM/LOGO	208-7069-00	2	2	2	
		BRKT: 3.5" FRONT ACCESS COVER MTG	208-7070-00	1	1	1	
		BUS BAR: GRD/TERM, 200A, 0.125 x 1.25 x 8.25"	209-3300-00	2			
		BUS BAR: GRD/TERM, 200A, 0.125 x 1.6 x 10.25"	209-3301-00		2	2	
		SCREW: STL, MS, SEMS, 6-32 x 3/8 PHIL P/HD	210-1430-00	2	2	2	10 IN. LBS.
	10	SCREW: STL, SEMS, 6-32 x 7/8 PHIL P/HD	210-1470-02	2	2	2	10 IN. LBS.
		SCREW: STL, MS, 10-24 x 3/4" PHIL P/HD	210-1750-00	4	4	4	27 IN. LBS.
		SCREW: STL IND HEX HD SEM, 1/4 x 1/2", ZINC	210-7004-01	4	4	4	45 IN. LBS.
		NUT, HEX STL: 2-56, Z SMALL PATTERN	211-0463-00	2	2	2	10 IN. LBS.
		NUT, HEX STL: 6-32, ZINC, 5/16" AF "KEPS"	211-0476-00	4	4	4	10 IN. LBS.
	15	NUT, HEX STL: 10-24, ZINC, "KEPS"	211-0492-00	4	4	4	27 IN. LBS.
		LOCKWASHER, SHKPF: 1/4 INTERNAL	212-0500-00	2	2	2	
		LOCKWASHER: DISH, STL, SHKPF, #6	212-0501-05	5	5	5	
		SPACER: HEX BRASS, 6-32 x .250 2320 SM	213-0105-00	2	2	2	
		SPACER: HEATSINK, HEX FIBERGLASS, 1", GLASTIC	213-1409-00	2	2	2	
	20	INSULATED BRKT: BUS SUPPORT 200A	213-3377-00	1	1	1	
		LABEL: 200A, BLACK	225-2921-00	1	1	1	
		NOMINCLATURE LABEL	225-3094-09	1	1	1	

200 AMP GRD/TERM ASSEMBLY
(111-3774-11 SHOWN)

FIG. 1

PROPRIETARY INFORMATION		
NOT TO BE COPIED, USED, TRANSMITTED, OR DISCLOSED WITHOUT PRIOR WRITTEN PERMISSION FROM UNIPOWER, LLC.		
SIZE B	DOC TYPE / NUMBER PN 111-3774	ISSUE 4
SCALE: NONE	SHEET: B1 OF	FILE NAME: PN111-3774_SHT_B1_ISS_4

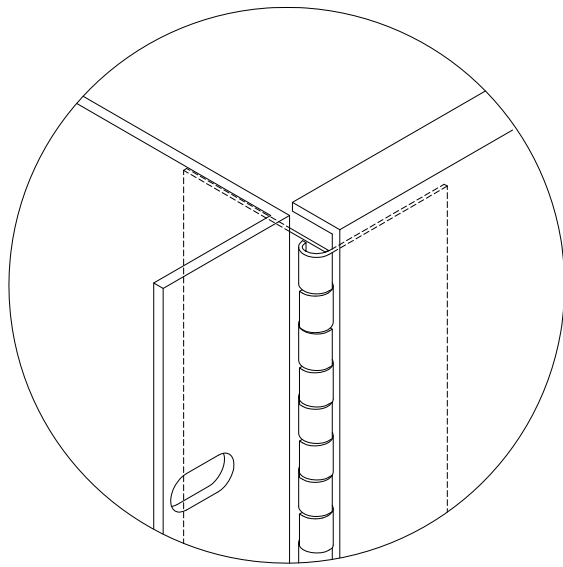

HINGE DETAIL

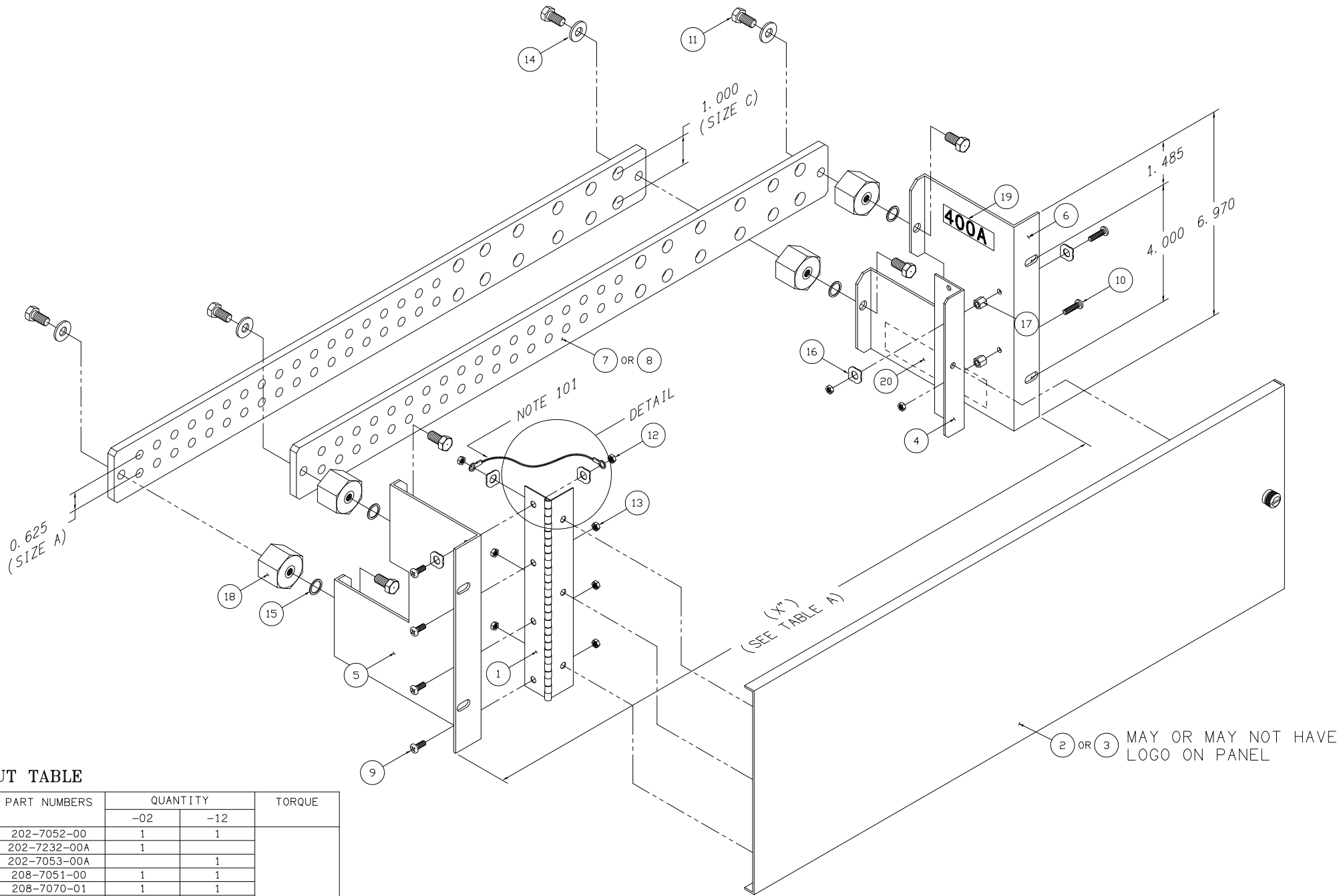

400 AMP CALLOUT TABLE

NOTE	REF #	DESCRIPTION	PART NUMBERS	QUANTITY		TORQUE
				-02	-12	
	1	HINGE: 7" PANEL COVER	202-7052-00	1	1	
		GRD/TERM HINGED PANEL, 19" x 7"	202-7232-00A	1		
		GRD/TERM HINGED PANEL, 23" x 7"	202-7053-00A		1	
		BRKT: 7" FRONT ACCESS COVER MTG	208-7051-00	1	1	
		BRKT, LEFT: FRONT ACCESS GRD/TERM/LOGO, 7"	208-7070-01	1	1	
	5	BRKT, RIGHT: FRONT ACCESS GRD/TERM/LOGO, 7"	208-7070-02	1	1	
		BUS BAR: GRD/TERM, 400A, 0.25 x 1.6 x 17.0"	209-3308-00	2		
		BUS BAR: GRD/TERM, 400A, 0.25 x 1.6 x 21.0"	209-3309-00		2	
		SCREW: STL,MS,SEMS, 6-32 x 3/8 PHIL P/HD	210-1430-00	4	4	
	10	SCREW: STL,SEMS, 6-32 x 7/8 PHIL P/HD	210-1470-02	2	2	
		SCREW: STL,SEMS, HEX HD, 1/4-20 x 5/8"	210-7004-40	8	8	10 IN. LBS.
		NUT, HEX STL: 2-56, Z SMALL PATTERN	211-0463-00	2	2	10 IN. LBS.
		NUT, HEX STL: 6-32, ZINC, 5/16" AF "KEPS"	211-0476-00	7	7	10 IN. LBS.
		WASHER: FLAT STL, 1/4 SAE, 5/8"	212-0099-00	4	4	
	15	LOCKWASHER, SHKPF: 1/4 INTERNAL	212-0500-00	4	4	
		LOCKWASHER: DISH, STL, SHKPF, #6	212-0501-05	5	5	
		SPACER: HEX BRASS, 6-32 x .250 2320 SM	213-0105-00	2	2	
		SPACER: HEATSINK, HEX FIBERGLASS, 1", GLASTIC	213-1409-00	4	4	
		LABEL: 400A, BLACK	225-2922-00	1	1	
	20	NOMINCLATURE LABEL	225-3094-09	1	1	

400 AMP GRD/TERM ASSEMBLY
(111-3774-12 SHOWN)

FIG. 2

PROPRIETARY INFORMATION		
NOT TO BE COPIED, USED, TRANSMITTED, OR DISCLOSED WITHOUT PRIOR WRITTEN PERMISSION FROM UNIPOWER, LLC.		
SIZE B	DOC TYPE / NUMBER PN 111-3774	ISSUE 4
SCALE: NONE	SHEET: C1 OF	FILE NAME: PN111-3774_SHT_C1_ISS_4

A

B

C

D

1

2

3

4

A

B

C

D

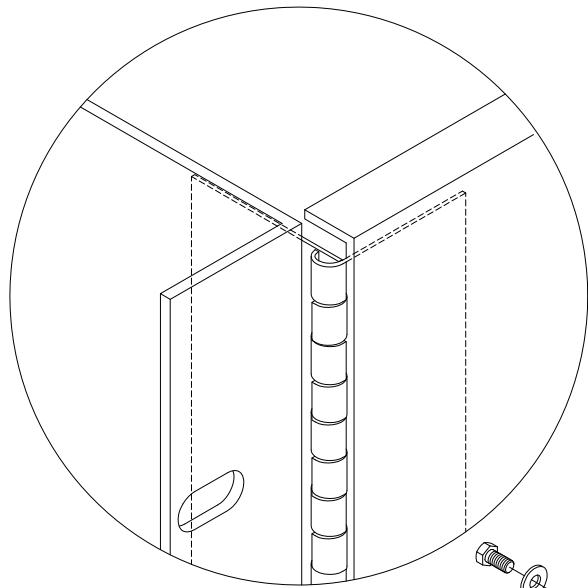

HINGE DETAIL

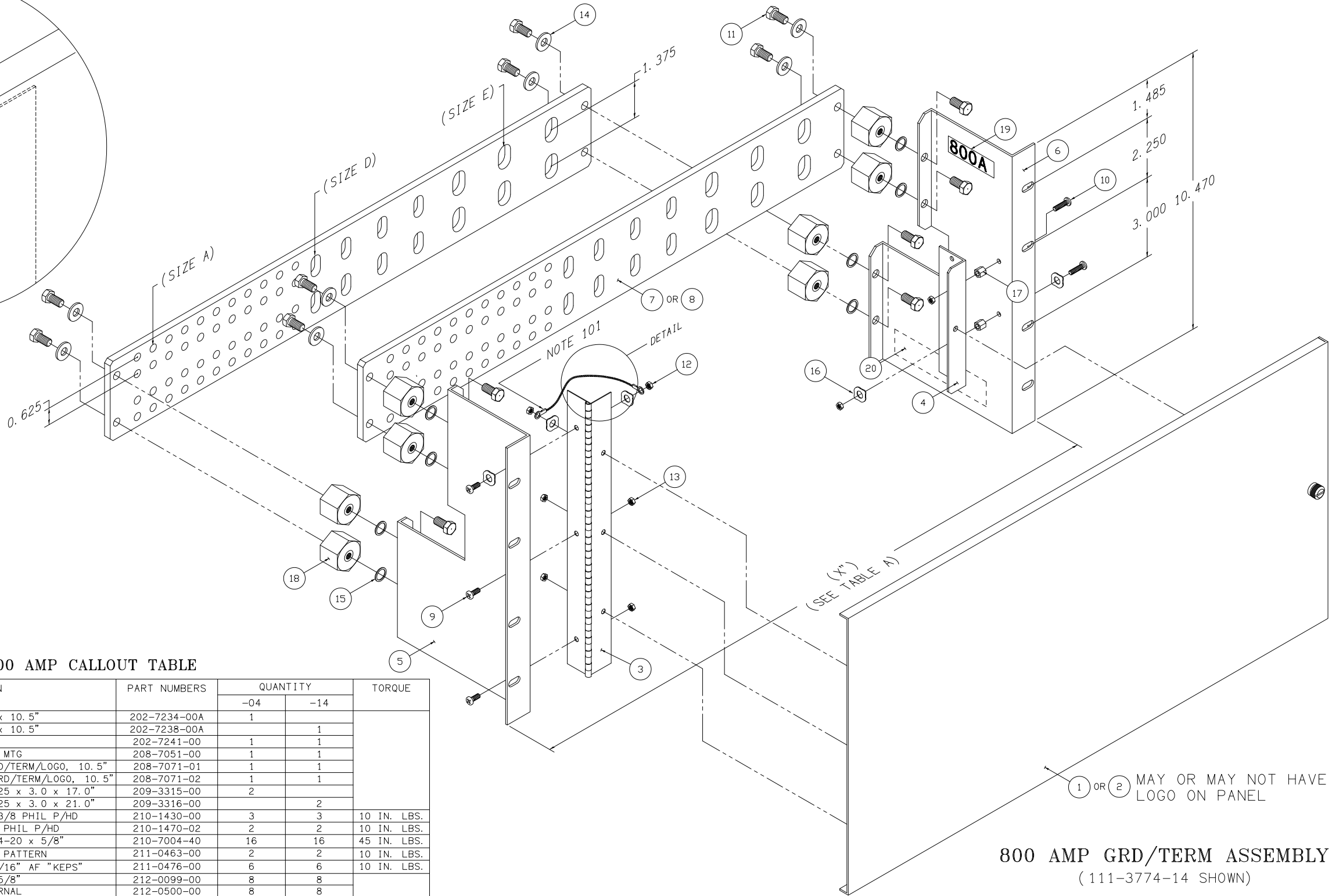

800 AMP CALLOUT TABLE

NOTE	REF #	DESCRIPTION	PART NUMBERS	QUANTITY		TORQUE
				-04	-14	
	1	GRD/TERM HINGED PANEL, 19" x 10.5"	202-7234-00A	1		
		GRD/TERM HINGED PANEL, 23" x 10.5"	202-7238-00A		1	
		HINGE" 10.5" PANEL COVER	202-7241-00	1	1	
		BRKT: 7" FRONT ACCESS COVER MTG	208-7051-00	1	1	
	5	BRKT, LEFT: FRONT ACCESS GRD/TERM/LOGO, 10.5"	208-7071-01	1	1	
		BRKT, RIGHT: FRONT ACCESS GRD/TERM/LOGO, 10.5"	208-7071-02	1	1	
		BUS BAR: GRD/TERM, 800A, 0.25 x 3.0 x 17.0"	209-3315-00	2		
		BUS BAR: GRD/TERM, 800A, 0.25 x 3.0 x 21.0"	209-3316-00		2	
		SCREW: STL,MS,SEMS, 6-32 x 3/8 PHIL P/HD	210-1430-00	3	3	10 IN. LBS.
	1	SCREW: STL,SEMS, 6-32 x 7/8 PHIL P/HD	210-1470-02	2	2	10 IN. LBS.
		SCREW: STL,SEMS, HEX HD, 1/4-20 x 5/8"	210-7004-40	16	16	45 IN. LBS.
		NUT, HEX STL: 2-56, Z SMALL PATTERN	211-0463-00	2	2	10 IN. LBS.
		NUT, HEX STL: 6-32, ZINC, 5/16" AF "KEPS"	211-0476-00	6	6	10 IN. LBS.
		WASHER: FLAT STL, 1/4 SAE, 5/8"	212-0099-00	8	8	
	1	LOCKWASHER, SHKPF: 1/4 INTERNAL	212-0500-00	8	8	
		LOCKWASHER: DISH, STL, SHKPF, #6	212-0501-05	5	5	
		SPACER: HEX BRASS, 6-32 x .250 2320 SM	213-0105-00	2	2	
		SPACER: HEATSINK, HEX FIBERGLASS, 1", GLASTIC	213-1409-00	8	8	
		LABEL: 800A, BLACK	225-2924-00	1	1	
	2	NOMINCLATURE LABEL	225-3094-09	1	1	

800 AMP GRD/TERM ASSEMBLY
(111-3774-14 SHOWN)

FIG. 3

PROPRIETARY INFORMATION		
NOT TO BE COPIED, USED, TRANSMITTED, OR DISCLOSED WITHOUT PRIOR WRITTEN PERMISSION FROM UNIPOWER, LLC.		
SIZE B	DOC TYPE / NUMBER PN 111-3774	ISSUE 4
SCALE: NONE	SHEET: D1 OF	FILE NAME: PN111-3774_SHT_D1_ISS_4

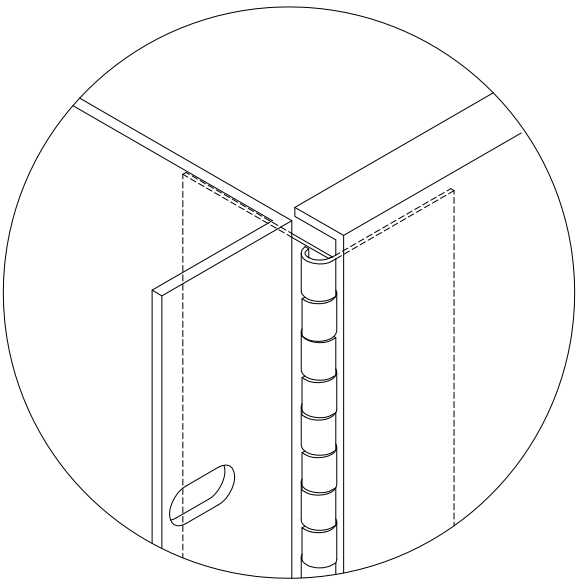

HINGE DETAIL

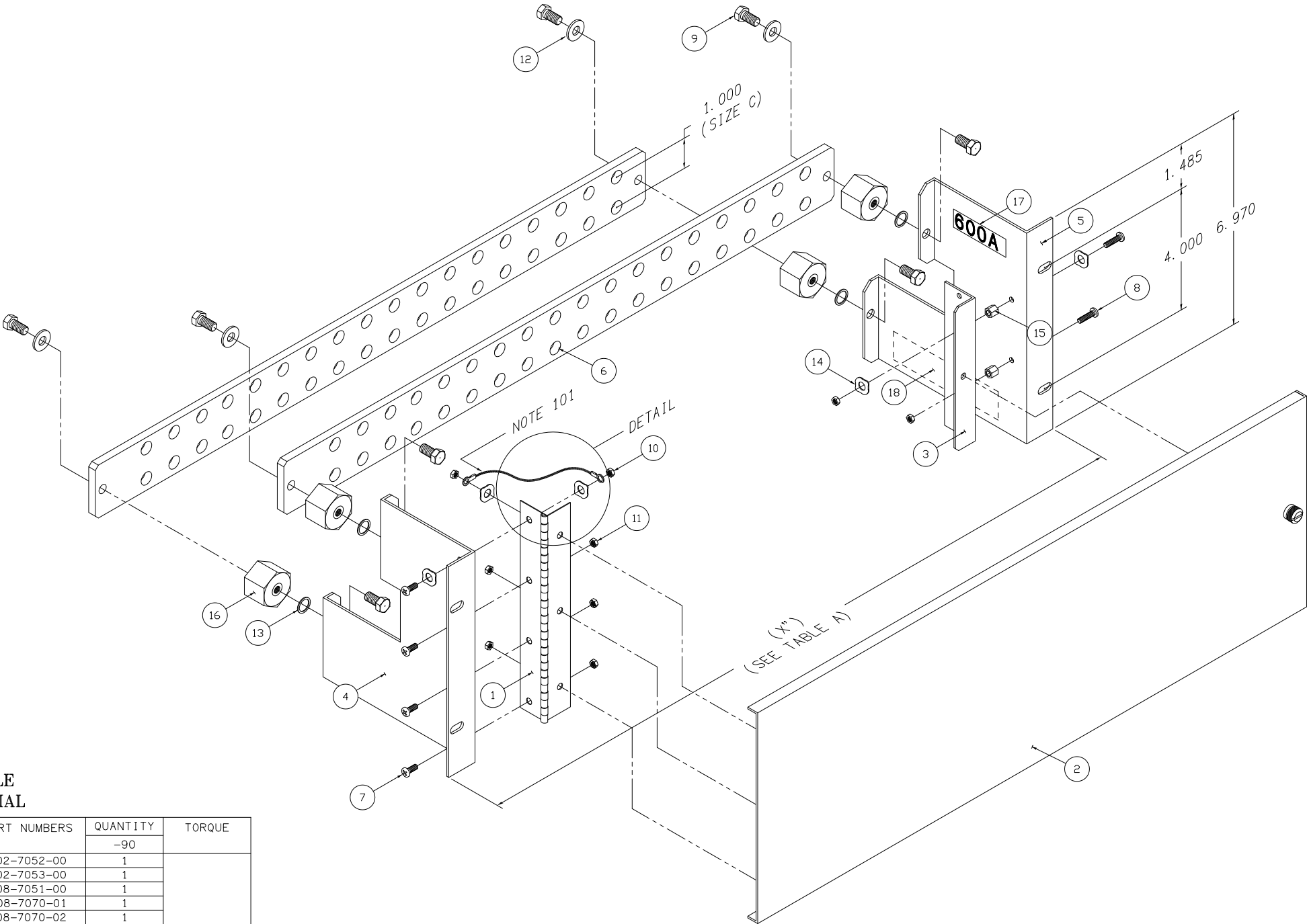

CALLOUT TABLE
600 AMP SPECIAL

NOTE	REF #	DESCRIPTION	PART NUMBERS	QUANTITY	TORQUE
				-90	
	1	HINGE: 7" PANEL COVER	202-7052-00	1	
		GRD/TERM/LOGO HINGED PANEL, 23" x 7"	202-7053-00	1	
		BRKT: 7" FRONT ACCESS COVER MTG	208-7051-00	1	
		BRKT, LEFT: FRONT ACCESS GRD/TERM/LOGO, 7"	208-7070-01	1	
	5	BRKT, RIGHT: FRONT ACCESS GRD/TERM/LOGO, 7"	208-7070-02	1	
		BUS BAR: GRD/TERM, 600 AMP, SPECIAL PATTERN	209-2961-20	2	
		SCREW: STL, MS, SEMS, 6-32 x 3/8 PHIL P/HD	210-1430-00	4	
		SCREW: STL, SEMS, 6-32 x 5/8 PHIL P/HD	210-1460-01	2	
		SCREW: STL, SEMS, HEX HD, 1/4-20 x 5/8"	210-7004-40	8	10 IN. LBS.
	10	NUT, HEX STL: 2-56, Z SMALL PATTERN	211-0463-00	2	
		NUT, HEX STL: 6-32, ZINC, 5/16" AF "KEPS"	211-0476-00	7	
		WASHER: FLAT STL, 1/4 SAE, 5/8"	212-0099-00	4	
		LOCKWASHER, SHKPF: 1/4 INTERNAL	212-0500-00	4	45 IN. LBS.
		LOCKWASHER: DISH, STL, SHKPF, #6	212-0501-05	5	
	15	SPACER: HEX BRASS, 6-32 x .250 2320 SM	213-0105-00	2	
		SPACER: HEATSINK, HEX FIBERGLASS, 1", GLASTIC	213-1409-00	4	
		LABEL: 600A, BLACK	225-2923-00	1	10 IN. LBS.
		NOMINCLATURE LABEL	225-3094-09	1	
	20				

600 AMP SPECIAL
GROUND/TERM ASSEMBLY
(111-3774-90 SHOWN)

FIG. 4

PROPRIETARY INFORMATION		
NOT TO BE COPIED, USED, TRANSMITTED, OR DISCLOSED WITHOUT PRIOR WRITTEN PERMISSION FROM UNIPOWER, LLC.		
SIZE B	DOC TYPE / NUMBER PN 111-3774	ISSUE 3
SCALE: NONE	SHEET: E1 OF	FILE NAME: PN111-3774_SHT_E1_ISS_3

A

B

C

D

A

B

C

D

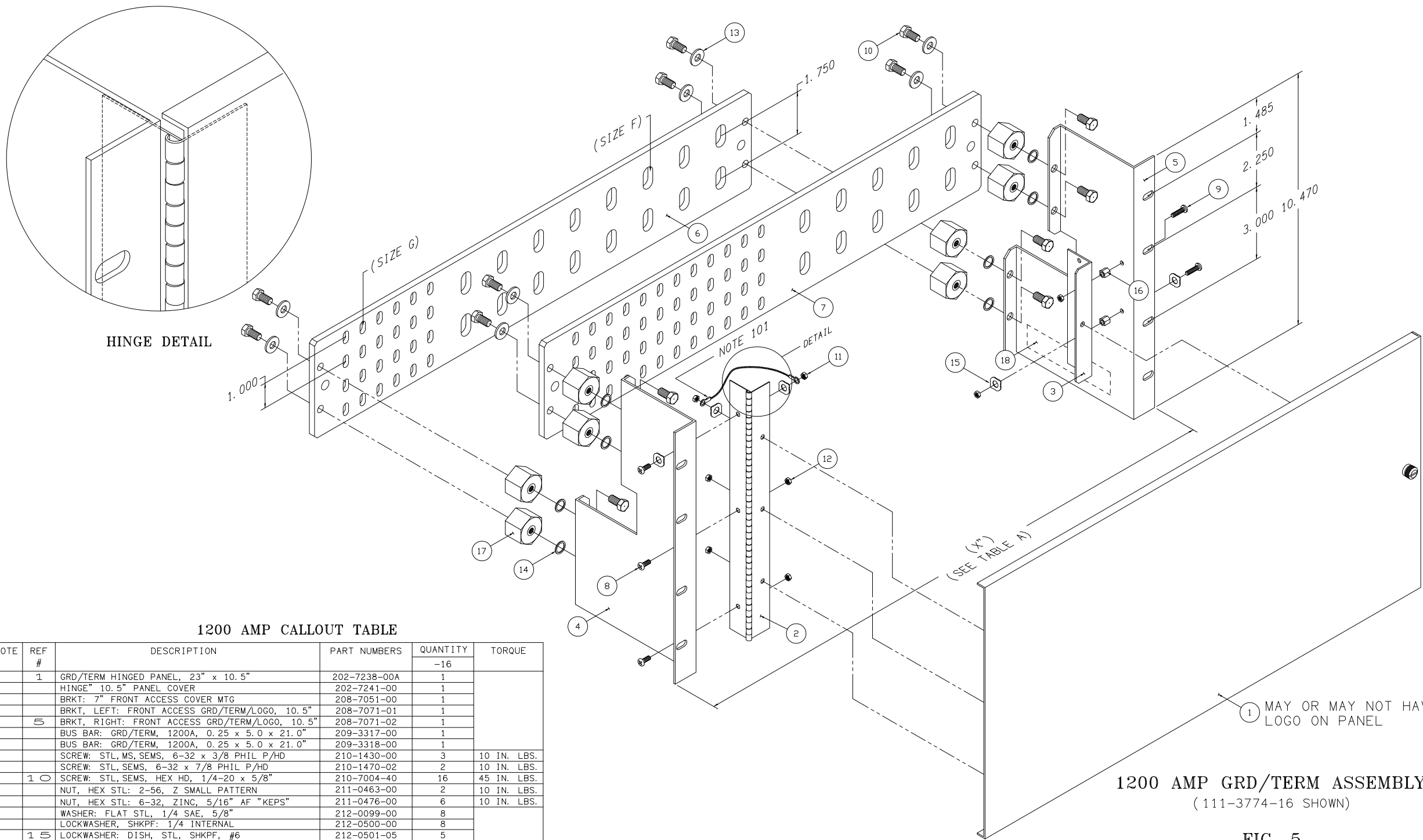

1200 AMP CALLOUT TABLE

NOTE	REF #	DESCRIPTION	PART NUMBERS	QUANTITY	TORQUE
				-16	
	1	GRD/TERM HINGED PANEL, 23" x 10.5"	202-7238-00A	1	
		HINGE" 10.5" PANEL COVER	202-7241-00	1	
		BRKT: 7" FRONT ACCESS COVER MTG	208-7051-00	1	
		BRKT, LEFT: FRONT ACCESS GRD/TERM/LOGO, 10.5"	208-7071-01	1	
	5	BRKT, RIGHT: FRONT ACCESS GRD/TERM/LOGO, 10.5"	208-7071-02	1	
		BUS BAR: GRD/TERM, 1200A, 0.25 x 5.0 x 21.0"	209-3317-00	1	
		BUS BAR: GRD/TERM, 1200A, 0.25 x 5.0 x 21.0"	209-3318-00	1	
		SCREW: STL, MS, SEMS, 6-32 x 3/8 PHIL P/HD	210-1430-00	3	10 IN. LBS.
		SCREW: STL, SEMS, 6-32 x 7/8 PHIL P/HD	210-1470-02	2	10 IN. LBS.
	10	SCREW: STL, SEMS, HEX HD, 1/4-20 x 5/8"	210-7004-40	16	45 IN. LBS.
		NUT, HEX STL: 2-56, Z SMALL PATTERN	211-0463-00	2	10 IN. LBS.
		NUT, HEX STL: 6-32, ZINC, 5/16" AF "KEPS"	211-0476-00	6	10 IN. LBS.
		WASHER: FLAT STL, 1/4 SAE, 5/8"	212-0099-00	8	
		LOCKWASHER, SHKPF: 1/4 INTERNAL	212-0500-00	8	
	15	LOCKWASHER: DISH, STL, SHKPF, #6	212-0501-05	5	
		SPACER: HEX BRASS, 6-32 x .250 2320 SM	213-0105-00	2	
		SPACER: HEATSINK, HEX FIBERGLASS, 1", GLASTIC	213-1409-00	8	
		NOMINCLATURE LABEL	225-3094-09	1	
	20				

1 MAY OR MAY NOT HAVE LOGO ON PANEL

1200 AMP GRD/TERM ASSEMBLY
(111-3774-16 SHOWN)

FIG. 5

PROPRIETARY INFORMATION		
NOT TO BE COPIED, USED, TRANSMITTED, OR DISCLOSED WITHOUT PRIOR WRITTEN PERMISSION FROM UNIPOWER, LLC.		
SIZE B	DOC TYPE / NUMBER PN 111-3774	ISSUE 4
SCALE: NONE	SHEET: F1 OF	FILE NAME: PN111-3774_SHT_F1_ISS_4