

A

B

C

D

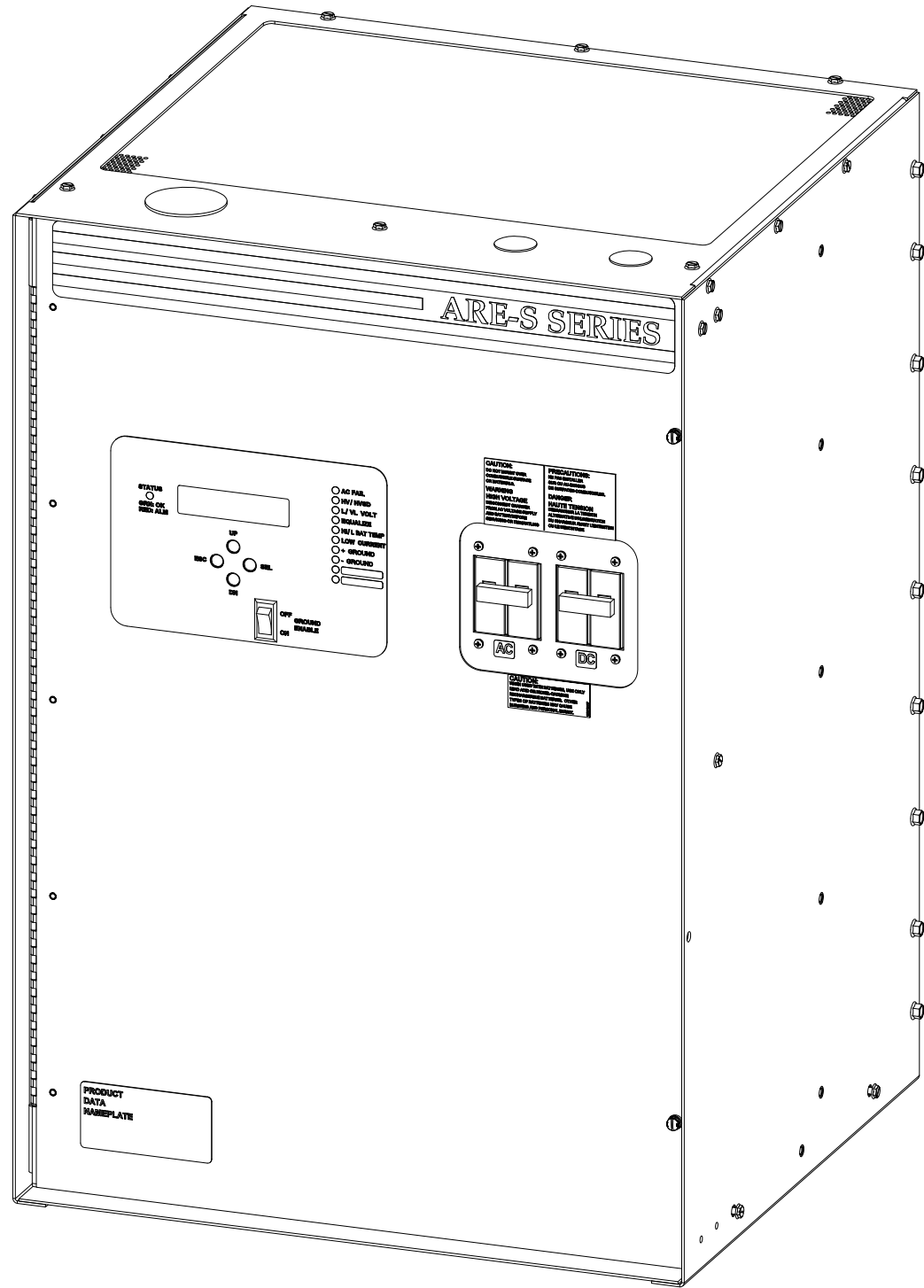

SHEET #	DESCRIPTION
1	COVER SHEET & NOTES
2	CABINET OUTLINE
3	CABINET ARRANGEMENT
4	TABLE A: COMPONENT LIST TABLE B: AC BREAKER RATINGS

Rapid Installation and Operation Information

- Unpack and install the charger per the manual.
- Turn on the ac breaker
- Allow the charger to start and reach the set voltage
- Turn on the dc breaker.

If the factory default settings are acceptable, the charger is ready for service.

To change any settings, consult the “Quick Reference Program Chart” to change voltages settings and time delays.

The charger menu returns to the default display if no buttons are pushed for five (5) minutes.

Specifications

Input Voltage:	240/480 V
Input Current:	80/40 A
Input Circuit Breaker	100/50 A
Input Circuit Breaker Interrupt:	Standard – 10 kA on 240 V Optional – 22 kA and 42 kA on 240 V Standard – 18 kA on 480 V Optional – 25 kA and 65 kA on 480 V
Output Voltage:	132 V, dc
Output Current:	75 A
Output Circuit Breaker:	100 A
Output Circuit Breaker Interrupt:	Standard – 10 kA Optional – 42 kA

Consult order to determine what options are provided.

ISSUES

ISSUE #	DESCRIPTION	ISS. BY ISS. DATE	APP. BY APP. DATE
5	SEE ECN 20157. UPDATED WITH UNIPOWER LOGO/VERBIAGE.	WD 3/23/15	MCM 3/26/15

APPROVED

UNLESS OTHERWISE SPECIFIED DIMENSIONS ARE IN INCHES ± TOLERANCES ON:		APPROVALS	DATE
HOLES		DRAWN KEL	10/4/12
FRACTIONS		CHECKED CJM	10/9/12
DECIMALS (XX)		APPROVED MCM	10/9/12
DECIMALS (XXX)		APPROVED	
ANGLES			

SQUARE CORNERS AND ANGLES ARE 90° UNLESS OTHERWISE SPECIFIED.

WORKMANSHIP:

MATERIAL:

FINISH:

PROPRIETARY INFORMATION
NOT TO BE COPIED, USED, TRANSMITTED, OR DISCLOSED WITHOUT
PRIOR WRITTEN PERMISSION FROM UNIPOWER, LLC.



ARE-S13075
STANDARD DRAWINGS

SIZE B	DOC TYPE / NUMBER PN 102-1090-13075	ISSUE 5
SCALE: N/A	SHEET: 1 OF 4	FILE NAME: PN102-1090-13075_ISS_5

A

B

C

D

4

A

B

C

D

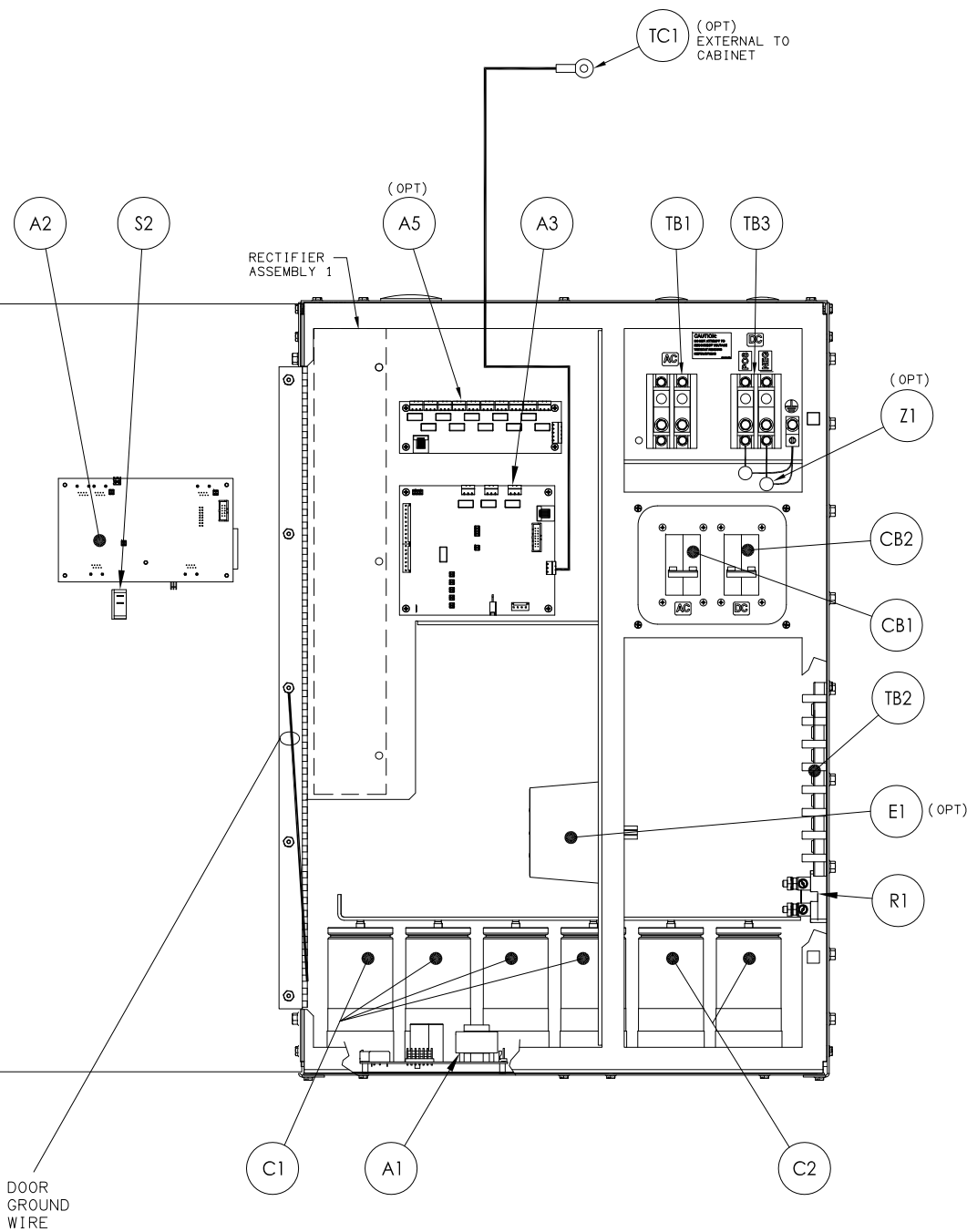

FRONT OF CABINET WITH
DOOR OPEN AND BACK PANEL
REMOVED FOR CLARITY

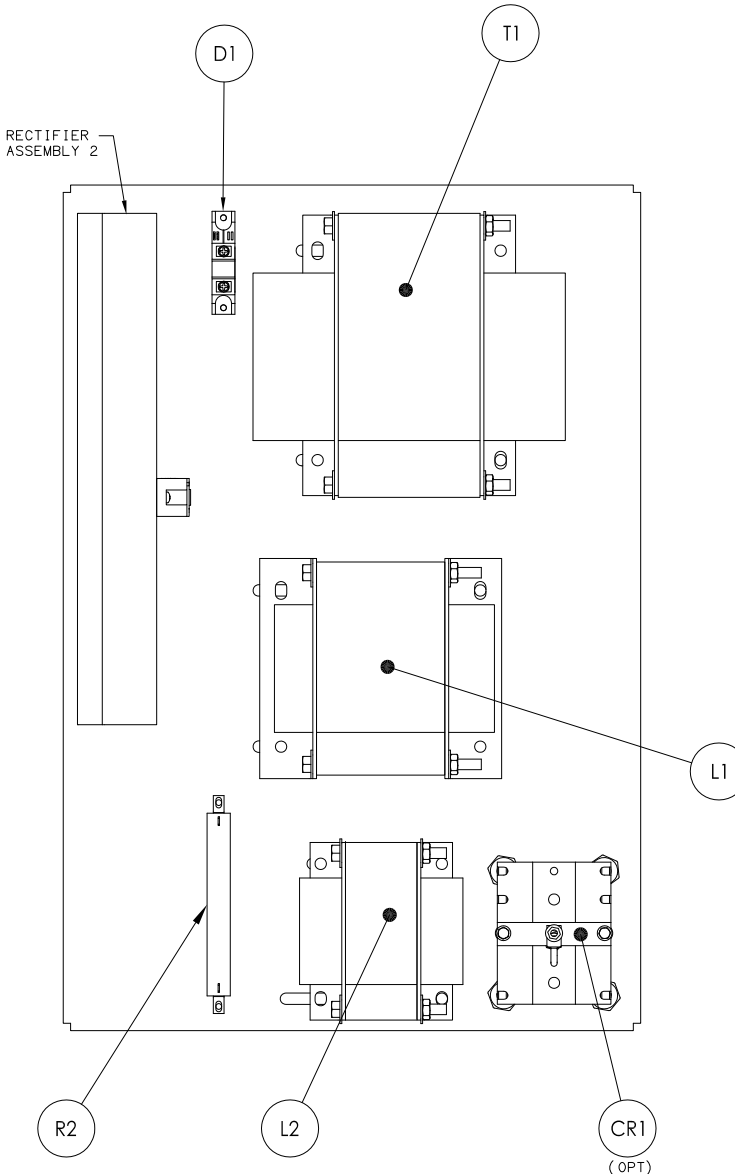

FRONT OF BACK PANEL

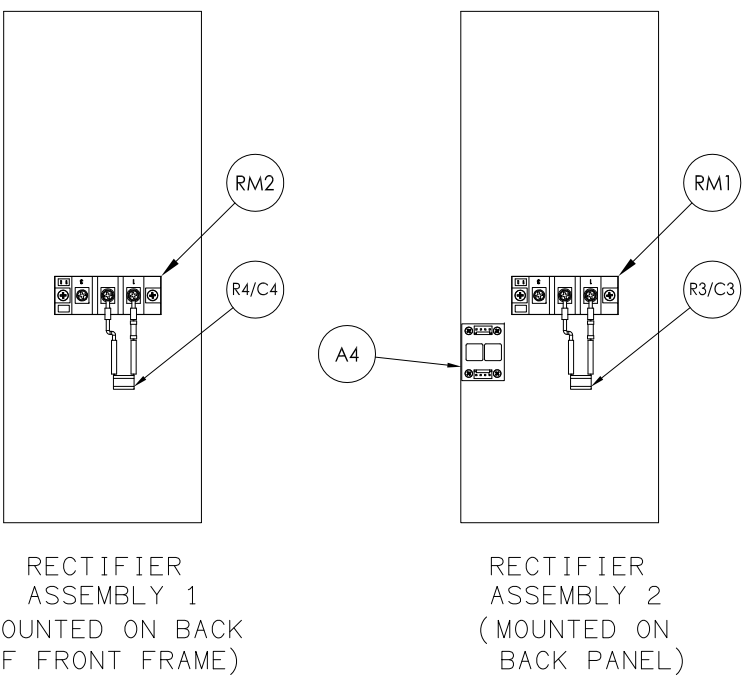

APPROVED

PROPRIETARY INFORMATION		
NOT TO BE COPIED, USED, TRANSMITTED, OR DISCLOSED WITHOUT PRIOR WRITTEN PERMISSION FROM UNIPOWER, LLC.		
SIZE B	DOC TYPE / NUMBER PN 102-1090-13075	ISSUE 5
SCALE: N/A	SHEET: 3 OF 4	FILE NAME: PN102-1090-13075_ISS_5

A

B

C

D

TABLE A

SEQ ID	DESCRIPTION	PART #	RECOMMENDED SPARE PARTS
A1	Power Supply PCB	306.2990.130	X
A2	Control and Display PCB	306.2993.00	X
A3	Interface PCB	306.2991.130	X
A4	Trigger Board	306.2989.00	X
A5	Additional Relay PCB (Opt)	306.2994.00	If option is in unit
C1	Cap, Filter	450.0830.00	
C2	Cap, Filter	450.0830.00	
CB1	Circuit Breaker, Input	SEE TABLE B	
CB2	Circuit Breaker, Output (Std)	JR00902	
CB2	Circuit Breaker, Output Hi-Cap (Opt)	272.0126.100	
CR1	Blocking Diode (Opt)	JS00548	If option is in unit
D1	Free Wheeling Diode	576.0500.00	X
E1	Lightning Arrestor 208240V (Opt)	JS00885	If option is in unit
E1	Lightning Arrestor 480V (Opt)	594.2041.00	If option is in unit
L1	Choke, Main	141.3421.00	
L2	Choke Secondary (Std)	141.3432.00	
L2	Choke Eliminator (Opt)	141.3430.00	
R1	Shunt (50mV)	JM00373	
R2	Resistor, Preload	685.0170.00	
R3/C3	Surge Protection	307.2724.00	
R4/C4	Surge Protection	307.2724.00	
RM1	SCR/Diode Module	583.0151.200	X
RM2	SCR/Diode Module	583.0151.200	X
S2	Ground Switch	240.4130.00	
T1	Transformer, Power 240/480V	143.3412.00	
TB1	Terminal Block	JL00898	
TB2	Terminal Block	252.0500.03	
TB3	Terminal Block	JL00898	
TC1	Thermosensor (Opt)	385.5627.11	If option is in unit
Z1	DC Output MOVs (Opt)	JA03079-150V	If option is in unit

TABLE B

Nominal Input Voltage	Interrupt Rating		
	10K	22K	42K
240V	272.0119.100	272.0121.100	272.0123.100
480V	272.0124.50	272.0125.50	272.0126.50

APPROVED

PROPRIETARY INFORMATION		
NOT TO BE COPIED, USED, TRANSMITTED, OR DISCLOSED WITHOUT PRIOR WRITTEN PERMISSION FROM UNIPOWER, LLC.		
SIZE B	DOC TYPE / NUMBER PN 102-1090-13075	ISSUE 5
SCALE: N/A	SHEET: 4 OF 4	FILE NAME: PN102-1090-13075_ISS_5