

DPGFIU SERIES FRONT ACCESS/CONNECT GMT DISTRIBUTION PANELS

DESCRIPTION

UNIPOWER's DPGFIU Series of all Front Connected GMT fuse distribution panels provide distribution and overload protection for 4/6 or 8/12 circuits. The one mounting position (1.75 inches) high GMT fuse panels provide 4/6 single-bus fuses or 8/12 dual-bus (A&B) fuses (4 or 6 per bus). They distribute up to a total of 160 amperes of load current from two separate 80-ampere sources with true A and B distribution and alarm capabilities.

A and B sections of the dual-bus panel are isolated and can be separately configured for 12, 24/48 volts and are polarity neutral.

Fuse sizes are ½ to 20 amperes. Fuse trip and power off alarm is indicated by an LED for each bus and one Form C relay contact per bus.

The panels come with brackets that permit mounting in either a 19- or 23-inch relay rack. They can be mounted from the front of the rack with offsets every quarter-inch from front to back to align with existing rack-mounted equipment.

FEATURES

- ◆ All Connections Made at the Front
- ◆ One Mounting Position High: 1.75"
- ◆ 19- or 23-Inch Rack Mounting
- ◆ GMT Fuses, ½A to 20A
- ◆ Single Bus with 4 or 6 Fuses
- ◆ Dual Bus (A/B) with 4 or 6 Fuses per Bus
- ◆ Bus Capacity: 80A per Bus
- ◆ Operating Voltage: 12, 24/48VDC
- ◆ POLARITY NEUTRAL
- ◆ A & B are Isolated Loads
- ◆ A & B Can Be Separately Configured
- ◆ Status LED
- ◆ One Form C Relay Contact per Bus

THREE YEAR WARRANTY

SAFETY COMPLIANCE

UL60950-1 2nd Edition
CSA22.2, No. 60950-1 2nd Edition
EN60950-1 2nd Edition



STANDARD MODELS

MODEL NUMBER	VOLTS EACH FEED	INPUT FEEDS	FUSES POSITIONS	AMPS EACH BUS	TOTAL AMPS
DPGFIU-A1-4	24/48	1	4 x ½ to 20A	64	64
DPGFIU-A6-4	12				
DPGFIU-A1-6	24/48	1	4 x ½ to 15A 2 x ½ to 20A	80	80
DPGFIU-A6-6	12				
DPGFIU-A1-4-B1-4	24/48	2	4 x ½ to 20A Each Feed	64	128
DPGFIU-A6-4-B6-4	12				
DPGFIU-A1-6-B1-6	24/48	2	4 x ½ to 15A 2 x ½ to 20A Each Feed	80	160
DPGFIU-A6-6-B6-6	12				

NOTE: The above are standard configurations. For voltage combinations not shown see the configuration guide on page 2 of this datasheet.

GMT FUSE ORDERING GUIDE

AMPS	COLOR	PART NUMBER
½	Red	401-1500-0010
¾	Brown	401-1500-0020
1	Gray	401-1500-0030
1	White	401-1500-0040
2	Orange	401-1500-0050
3	Blue	401-1500-0060
5	Green	401-1500-0070
10	Red/White	401-1500-0080
12	Green/Yellow	401-1500-0090
15	Red/Blue	401-1500-0110
20	Green/White	401-1523-0000
Dummy		401-1500-0100

NOTE: Fuses need to be ordered individually and are shipped with each panel as separate items for field installation.

SPECIFICATIONS

Typical at 25°C Unless Otherwise Noted.

INPUT / OUTPUT

Panel Capacity.....80A Per Bus, 160A Total
 Configuration.....Single Bus with 4 or 6 Fuses
 Dual Bus with 4 or 6 Fuses Each
 Fuse Type.....CMT
 Fuse Capacity¹.....4 x 15A max. with 2 x 20A max. OR 4 x 20A max.
 Voltage²
 24/48V Version.....21-60VDC
 12V Version.....10.5-15VDC
 Polarity.....Polarity Neutral

ALARMS

Alarm Indicator.....Dual-Color LED Per Bus
 LED Status Indication.....Green = Normal
 Red = Fuse Trip Alarm
 Off = No Power
 Alarm Connections.....One Form C Relay Contact Per Bus

SAFETY COMPLIANCE.....UL60950-1 2nd. Ed., CSA22.2 No.950-1 2nd Ed., EN60950-1 2nd. Ed.

ENVIRONMENTAL

Operating Temp. Range.....-10°C to +70°C
 Storage Temp. Range.....-40°C to + 85°C
 Humidity.....0% to 95%, Non-Condensing

PHYSICAL SPECIFICATIONS

Case Material.....Steel
 Finish.....Powder Coat Black
 Dimensions, Inches (mm).....1.75 H x 19.00 W x 9.00 D
 (44.5 x 483 x 229)
 Weight.....8.38 lbs. (3.80kg.)
 Rack Mounting Width.....19 or 23 Inches

CONNECTIONS

Input Connections.....Crimp Type Lug or ¼ - 20 Stud
 Output Connections.....Barrier Terminal Strips, No. 6-32
 Chassis Ground Connection.....No. 8-32 Stud
 Alarm Relay Connections.....Spring Clamp Terminals, 16-26AWG

NOTES:

1. See table for fuse sizes.
2. See Ordering Guide to specify voltage.

FRONT VIEW

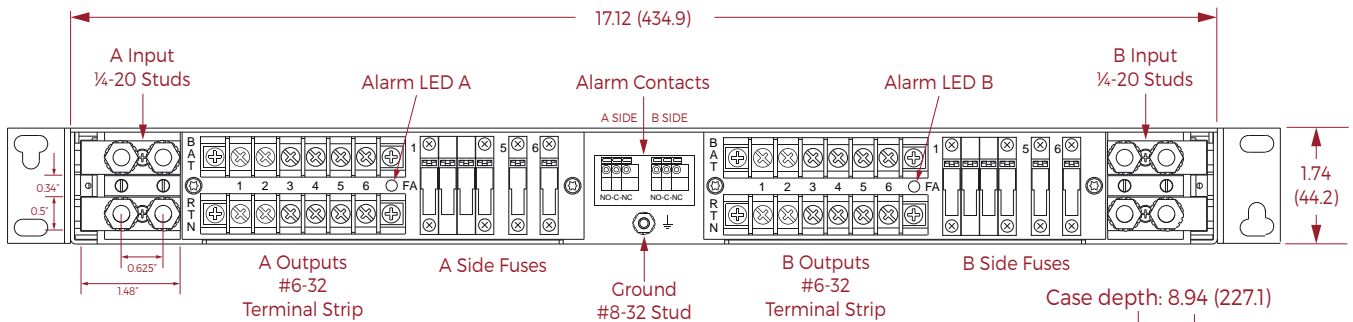

CONNECTION DETAILS

Crimp Lugs for input bus bars should be ordered separately.

For a kit of 4 two-hole lugs for #6AWG wire order part number 775-1434-0000.

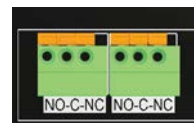
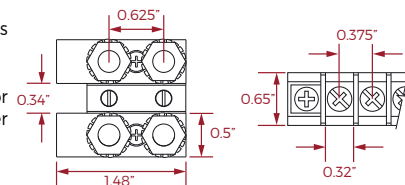

Connectors are Phoenix Contact spring clamp type. Wires (16-26AWG) do not require any termination.

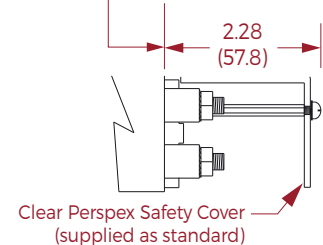

ALL DIMENSIONS IN INCHES (mm).

ORDERING GUIDE

CODE	VOLTAGE
1	24/48V
6	12V

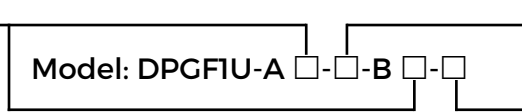

CODE	FUSE CONFIGURATION
4	4 X ½ to 20A
6	4 x ½ to 15A 2 x ½ to 20A

POLARITY NEUTRAL - May be connected for Positive or Negative Ground operation.

- Notes:**
1. If section B is not used a blank panel is installed at the factory and the "-B" is not required in the model number (see Standard Model label on page 1).
 2. The sum of all fuse currents on either side must not exceed 80 Amperes.