

12-1074



C&D TRUE FRONT ACCESS®

TEL Series
Float Service



TEL12-210F

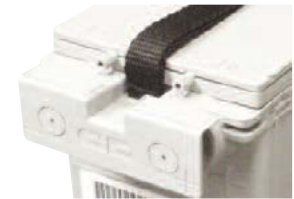

TEL12-210FG
with TFA gas
collection system



Typical Wireline Application



Typical Wireless Application

Benefits:

- Long Life Float Service Design
- Confirmed via 3rd party Certification
- Premium alloy and material components
- True Front Access Design
 - True direct connect terminal for reliability
 - C&D Ohmic Ring® for accurate testing
 - Optional True Front Access gas collection system (models contain "G" suffix)
 - Connection versatility
- Maximum Performance
 - Superior output due to direct terminal connection
 - Low internal resistance
- Compliant to major global specifications
 - British Standard BS 6290: Part 4: 1997
 - IEC 60896-21/22
 - Telcordia SR-4228
 - Eurobat Guide Classification: Long Life
 - Bellcore GR-63-CORE & GR-1089-CORE
 - UL94 V-0FR
 - Non-Hazardous, not restricted for any transportation mode (air, water or land)

SPECIFICATIONS

Battery	Voltage Per Unit	Ampere Hour Capacity 8 Hour Rate @ 77°F (25°C) to 1.75 v/c	Ampere Hour Capacity 10 Hour Rate @ 68°F (20°C) to 1.80 v/c	Maximum Discharge Current	Short Circuit Current	Ohms Impedance 60 Hz (Ω)	Battery Weight
TEL12-210F/FG	12 V	202 Ah	199 Ah	800 Amperes	4500 Amperes	0.0040 Ohms	132 lbs/60 kg

SPECIFICATIONS

Ampere Hour Capacity to 1.75 Volts per Cell @77°F (25°C)

Discharge in Hours

Model	1	2	3	4	5	6	7	8	10	12	20	24
TEL12-210F/FG	138	165	170	176	190	194	199	202	209	214	230	235

Ampere Hour Capacity to 1.80 Volts per Cell @77°F (25°C)

Discharge in Hours

Model	1	2	3	4	5	6	7	8	10	12	20	24
TEL12-210F/FG	126	153	153	158	175	179	183	186	192	198	212	218

DIMENSIONS

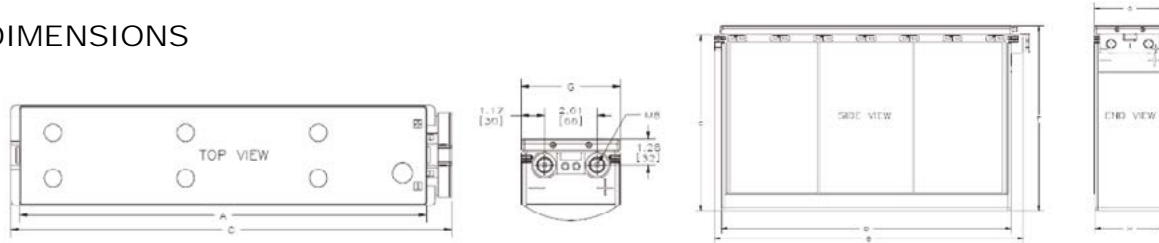

MODEL	A		B		C		D		E		F		G		H	
	in	mm	in	mm	in	mm	in	mm	in	mm	in	mm	in	mm	in	mm
TEL12-210F	20.3	516	21.5	546	22.0	559	20.1	512	12.2	310	12.6	320	4.9	126	4.8	123
TEL12-210FG	20.3	516	21.5	546	22.0	559	20.1	512	12.2	310	12.8	326	4.9	126	4.8	123

* All dimensions in inches and (millimeters). All dimensions are for reference only. Contact a UNIPOWER Representative for complete dimensional information.

Operating Temperature Range with temperature compensation	Discharge: -40°F (-40°C) to 160°F (71°C) Charge: -10°F (-23°C) to 140°F (60°C)
Nominal Operating Temperature Range	+68°F (20°C) to +80°F (27°C)
Recommended Maximum Charging Current Limit	C ₂₀ /5 Amperes (46A)
Float Charging Voltage	13.5 to 13.8 VDC average per 12V unit
Maximum AC Ripple (Charger)	0.5% RMS or 1.5% P-P of float charge voltage recommended for best results. Max AC ripple voltage allowed = 1.4% RMS (4% P-P) Max AC ripple current allowed = 11.5 amperes RMS (C ₂₀ /20)
Self Discharge	Battery can be stored up to 6 months at 77°F (25°C) before a freshening charge is required. Batteries stored at temperatures greater than 77°F (25°C) will require recharge sooner than batteries stored at lower temperatures. See C&D bulletin 41-7272, Self-Discharge and Inventory Control for details.
Equalize charge and cycle service voltage	4.40 to 14.80VDC average per 12V unit @ 77°F (25°C)
Terminal: Inserted - Inter-unit connector and hardware provided	Threaded copper alloy insert terminal to accept M8 bolt
Terminal Hardware Torque:	160 in.-lbs. (18 N-m)
Telcordia Part Numbers	Battery Part Number TEL12-210F/FG CLEI Code Pending CPR Pending